

# AMMOCONTROL

## Digital Counter for AR15

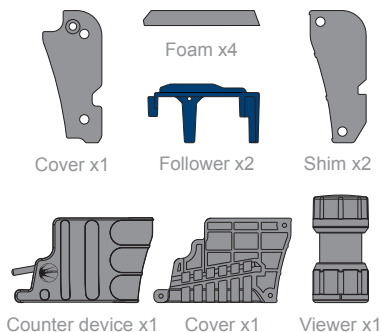

### PACKAGE CONTENTS



### TOOLS

\*Included

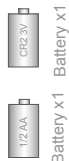

### ASSEMBLY · RIFLE

Install the foams for better fit if necessary (depending on the model of the rifle)

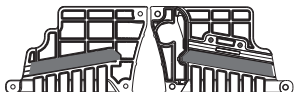

Battery assembly for counter device

Do not cover for a correct device operation.

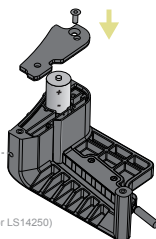

(Battery model: 1/2 AA or LS14250)

Attach **AMMOCONTROL** counter device to the lower receiver using screws and washers from the package

If necessary, install shims for better fit.

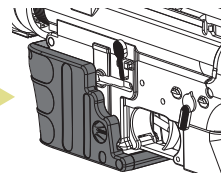
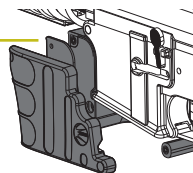

Installed

### ASSEMBLY · RIFLE

Battery assembly for viewer

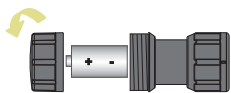

(Battery model: CR2 3V)

Attach viewer with a mounting ring(1") in a picatinny rail

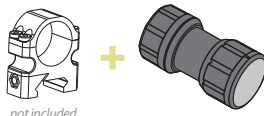

not included

### ASSEMBLY · MAGAZINE

Disassemble the magazine\* and change the original follower

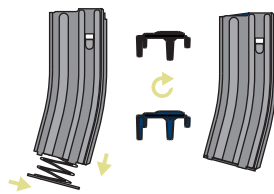

Supplied follower is compatible with most aluminium USGI spec magazines. It may require device calibration.

### ADDITIONAL DATA

- Never insert anything into the count sensor hole.
- Clean with water if it is dirty.
- Count error: 0,25%
- Initial total counts maybe different from zero. (Quality control)

### CALIBRATION

THE DEVICE HAS TWO DIFFERENT CALIBRATIONS

FIRST CALIBRATION:

#### 1. SHOT COUNTER CALIBRATION

Put a cartridge in the magazine and shoot.

Push the button until the viewer shows a green LED.

NOTE: You can repeat this procedure as many times as necessary.

SECOND CALIBRATION:

#### COUNTER ROUNDS IN THE MAGAZINE CALIBRATION

##### 1. MAGAZINE

Load 14 cartridges in the magazine.

##### 2. RIFLE

Load a cartridge in the chamber. (13 in mag.)

Push the button until green LED turns on. (5 sec)

#### 3. FIRE THE RIFLE

Shoot maintaining an interval of 2 seconds between each shot.

After each shot, the display will show the number of remaining cartridges.

After the last shot, the green LED will turn on. (Calibration mode complete)

#### 4. EXITING CALIBRATION MODE

Automatically after last shot. (Green LED).

#### 5. RESET

For reset the device, you have to release the battery of the counter device.

\*The device only works with original USGI mag. \*\*The device does NOT detect round housed in the chamber. Important: Always observe the basic safety rules when handling firearms.



001308

www.radetec.com · info@radetec.com



## KNOW YOUR AMMOCONTROL

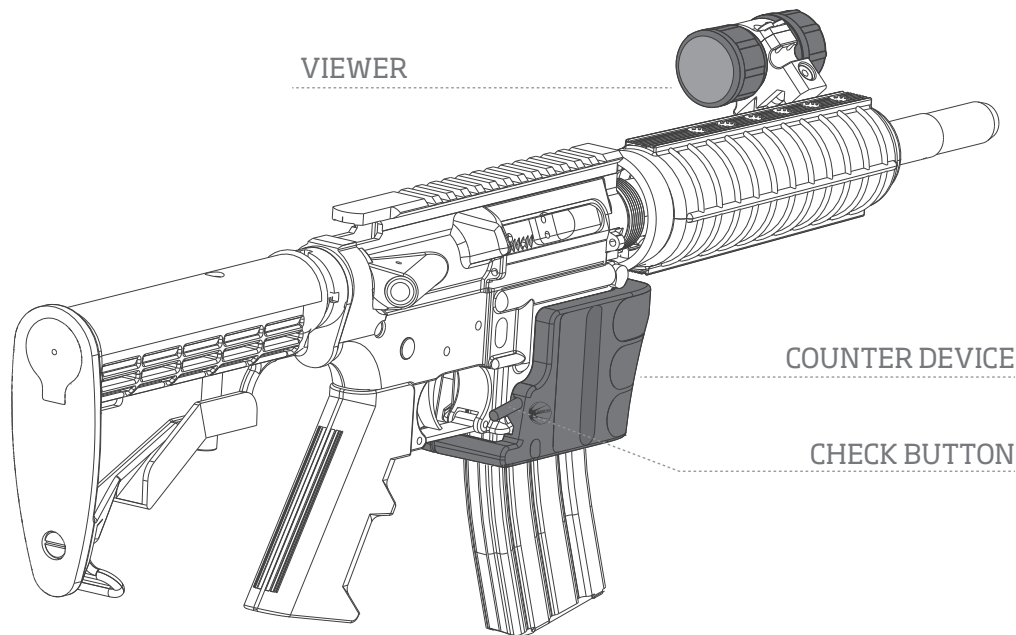

## DISPLAY ACTIVATION EVENTS

### ACTIVATION

- Firing the rifle.
- Pressing the check button.
- Pressing check button during 3 seconds to show the total number of shots fired.

### VIEWER: FIRING

Numbers **12 to 4 rd.**

Continuous Red (Slow) **3 rd.**

Continuous Red (Fast) **2 rd.**

Blinking Red (Slow) **1 rd.**

Blinking Red (Fast)\*\* **0 rd.**

### VIEWER: NO FIRING

Numbers **12 to 0 rd.**



### BATTERY LEVEL

Blue LED indicates that the viewer's battery is low.

(Battery model: CR2 3V)

Low battery counter device is indicated with:

**LB**

Battery model:  
(1/2 AA or LS14250) 3.6V

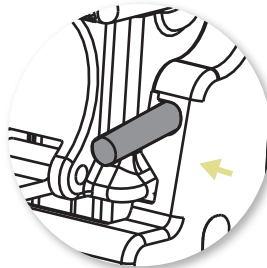

Push the check button to know the number\*\* of cartridges in the magazine.

Display intensity is automatically adjusted depending on ambient light.

### TOTAL FIRES VIEWER EXAMPLE

#### 42 SHOTS

1. -

2. 4

3. 2

4. -

Tested on: Oberland / Sabre defence / Olympic Arms / Colt

\*The device only works with original USGI mag. \*\*The device does NOT detect round housed in the chamber. **Important:** Always observe the basic safety rules when handling firearms.